

Disclaimer
 1. This drawing is the property of Cameo & Partners Ltd.
 2. It must not be copied or reproduced without written consent.
 3. Do not scale from this drawing.
 4. Check all dimensions on site before setting out.

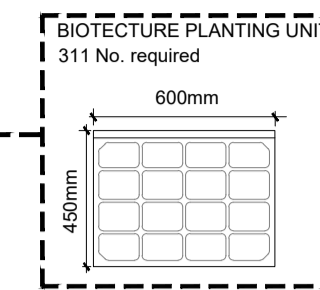

- 1 Elevation of green wall
403 scale 1:25@A1
- 1 Elevation of green wall
440 scale 1:50@A2

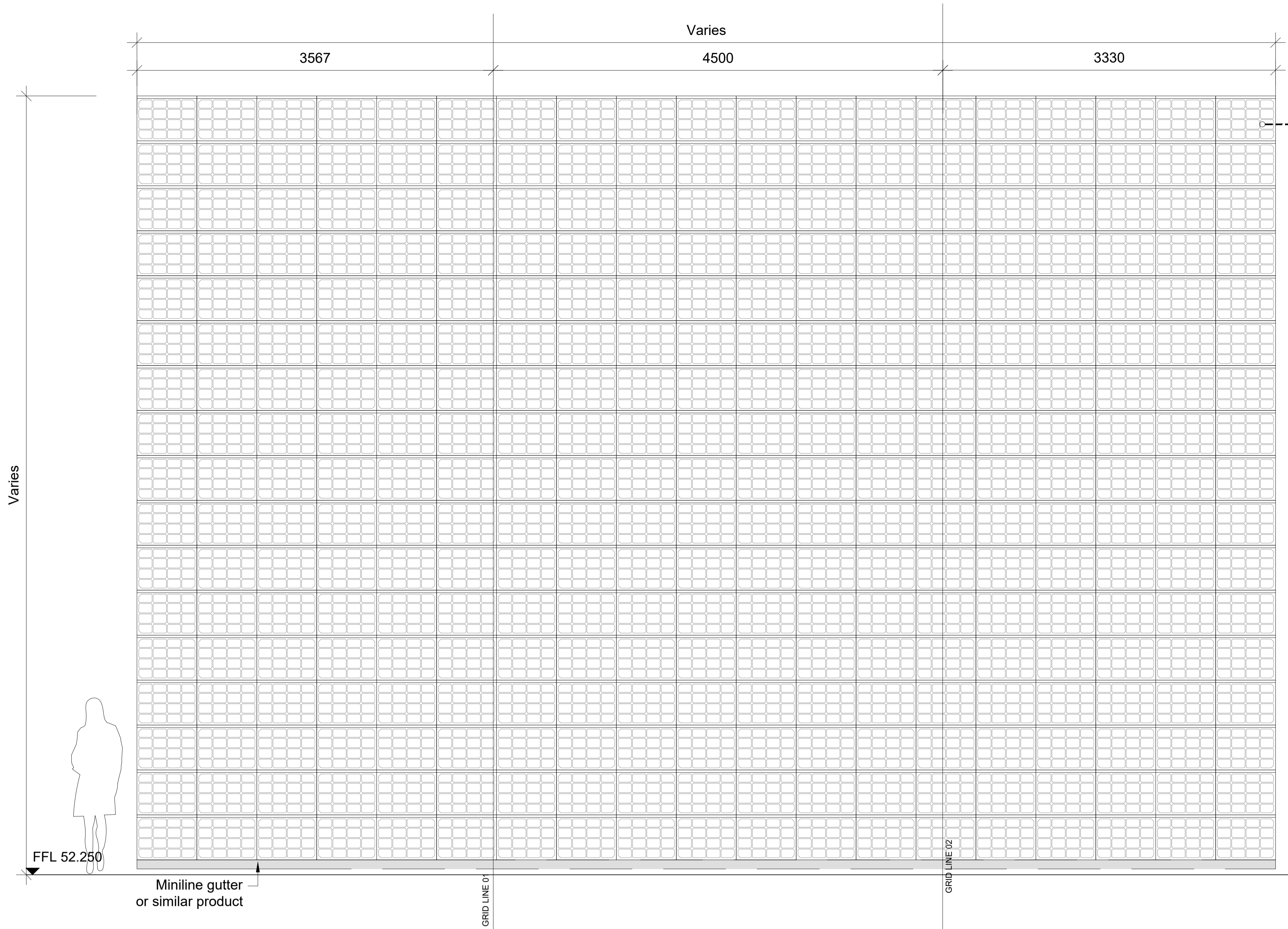
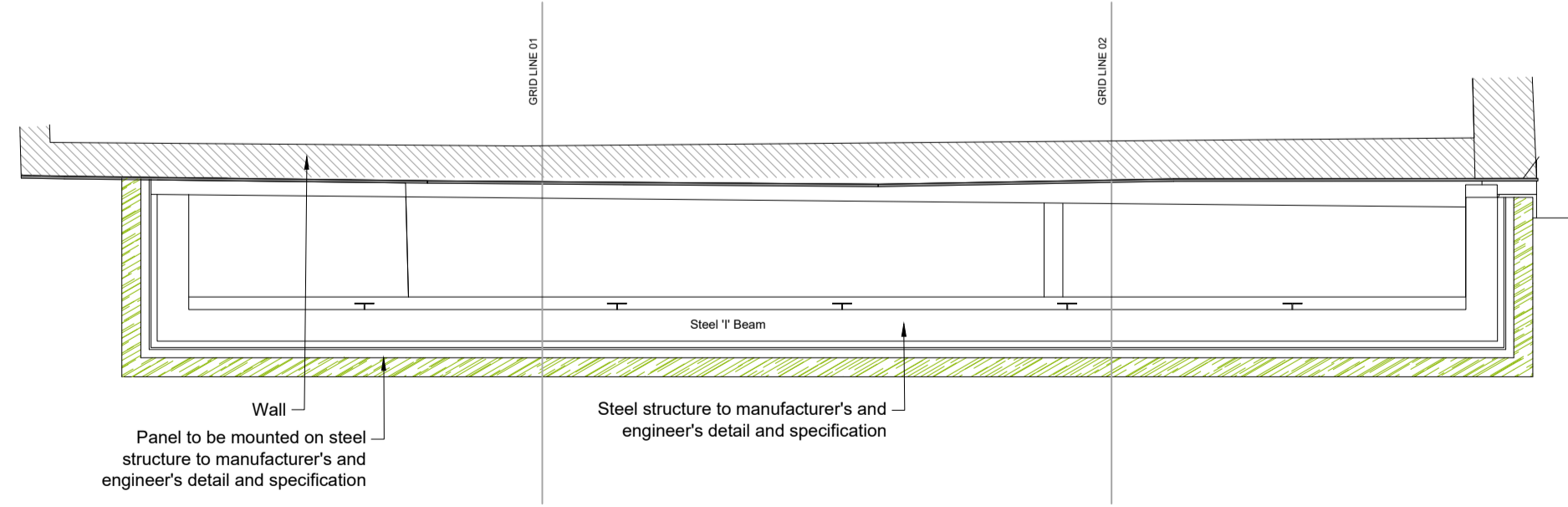

- 2 Plan view of green wall
403 scale 1:50@A1

- IMPORTANT NOTES:**
 THIS DRAWING IS NOT FOR CONSTRUCTION:
- The purpose of this layout to convey the design intent only. It is envisaged this information will be passed to a specialist who will make their own shop drawings. The chosen manufacturer will then submit their drawings to the client and design team for approval prior to fabrication.
 - Possible planter supplier: Biotecture
 - Chosen supplier to undertake site survey prior to design and fabrication. The measurements given on this layout are a guide only. Site measurements to be used prior to fabrication.
 - Post dimensions, fixings to be reviewed and approved by the project engineers.
 - Fixings shown indicative only, chosen supplier to confirm fittings prior to fabrication.
 - Planting depth showed a guide only and subject to confirmation of subcontractors from the project engineers or/and architects.
 - Wall height and dimensions shown one indicative only to confirmation of detail from the project structural engineers.

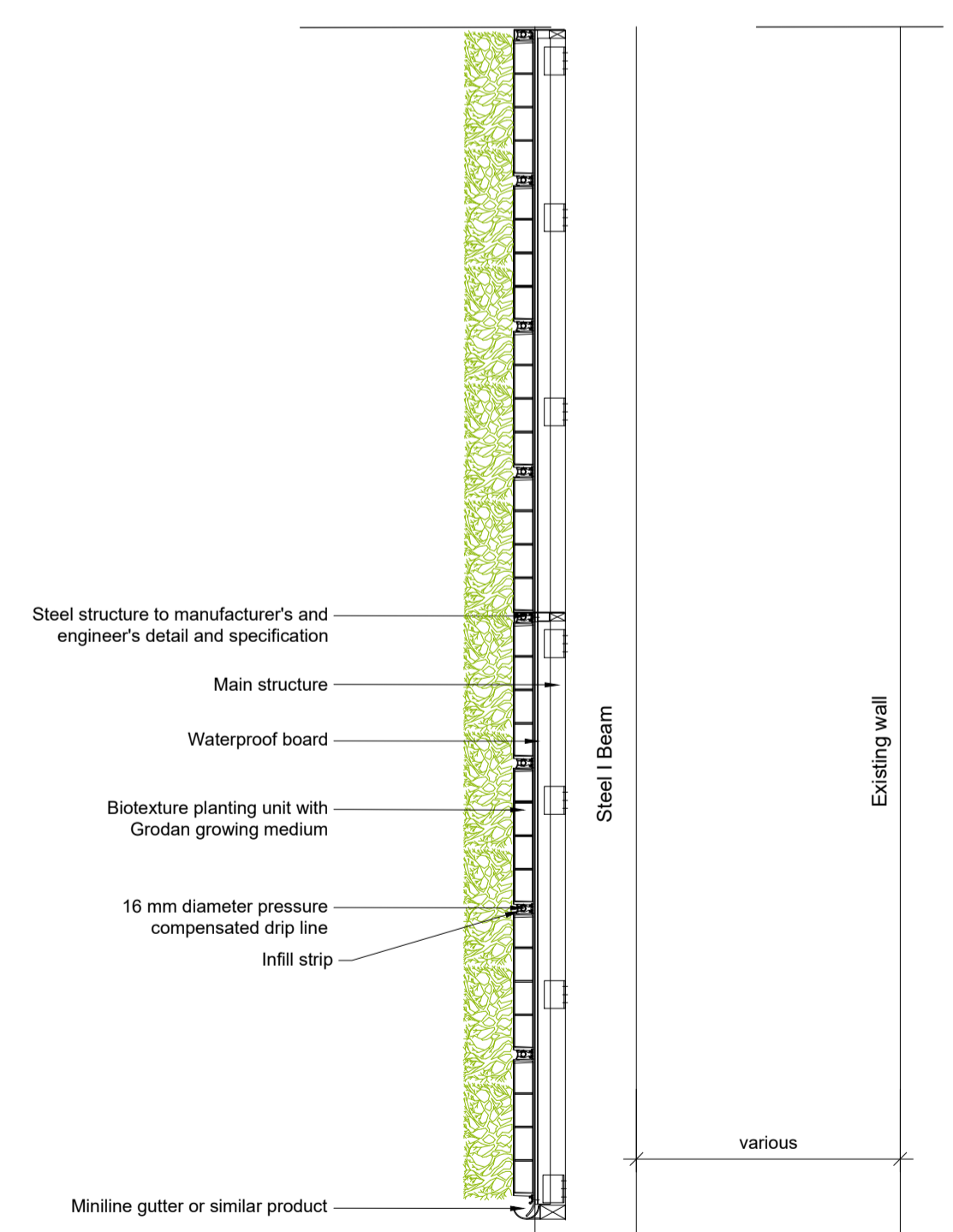

- 3 Typical detail of green wall
403 scale 1:20@A1

- The process for a BioWall installation:
- Agree panel layout, planting design and irrigation design
 - Plant panels on vertical racks in our nursery where they are nursed
 - First fix on site: irrigation plant room, cladding & support structure
 - Second fix on site: panels' installation complete with semi-mature plants
- Planting Design
- The planting design for the living walls takes into account the site parameters (location, aspect, adjacent features) as well as considering elements such as native or near-native plants, targeted plants for particular benefits (BREEAM / air pollution / indoor air quality / logo, etc.) and any other specific client requirements. These inputs are then woven into a design and plant brochure. Once agreed, the nursery process then follows a precise planting plan to create the finished panels.

KEY LOCATION PLAN

00	Issued for Information	HB	01.10.2019
rev	details	by	date

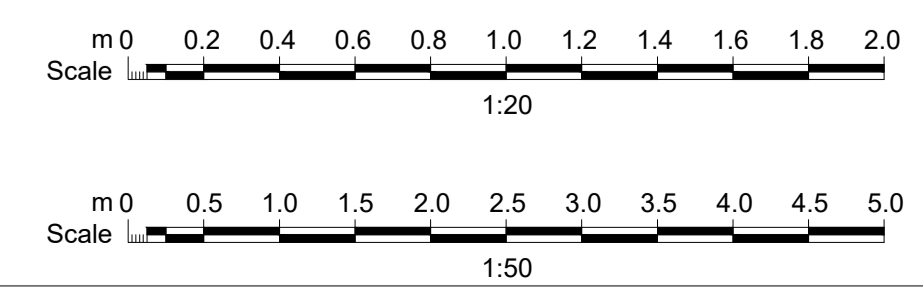

Project
 Cornelscourt Residential Development,
 Cabinteely, Dublin 18

Drawing
 Ground Floor, Typical Green Wall Detail

Scale	Date	Checked By	Drawn By
1:10@A1	30.09.2019	VK	GB
Drawing No.			Revision
C0098 L403			00
Purpose of Issue:			
P			
D = design information / P = planning / T = tender / C = construction / B = as built			
Drawing sheet size - A1			